



Power to scale

The new industry-standard media server powering the world's biggest and most technically demanding live and virtual productions.

Warranties & Support

- 2 year return to base hardware warranty

Bundled accessories

Keyboard
 Mouse
 Power Cable (Plug - True1)
 Hardware Guide
 Backmounted Rails

Optional accessories

Rack slides

Upgrades

(AS - At Sale, F - Field, RTM- Return to Manufacturer)

- Storage Upgrade 4x 3.84TB (15.36TB) ^{AS, F}
- Storage Upgrade 4x 7.68TB (30.72TB) ^{AS, F}
- Storage Upgrade 4x 15.36TB (61.44TB) ^{AS, F}

Physical specifications

Packed Dimensions:	W	H	D
	610mm 24.02"	395mm 15.55"	765mm 30.12"
Unit Dimensions:	W	H	D
	445mm 17.52"	178mm 7"	593mm 23.35"
Unit + Rack Handles	W	D	
	483mm 19"	621mm 24.45"	
Rack Depth:			D
			585mm 23.03"
Unit Weight:			EST.
			15 kg 33.1 lbs
Packed Unit Weight:			EST.
			22 kg 48.5 lbs

vx 4+ specs

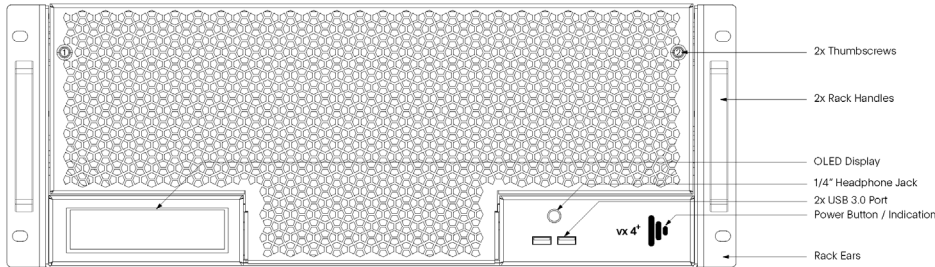

Hardware specifications

Voltage: 100-240V, 50-60Hz	Environmental Tolerances: Temperature: 5-35°C (40°-95°F)	Operating System: Windows 10 Enterprise SAC
Power Connection: Neutrik powerCon True1	Humidity: 5%-95% (non-condensing)	OS: 2x 256GB SSD
Power Consumption Peak: 785W	Altitude: 0-2700m (0-8850 ft)	Storage: 4x 1.92TB Removable NVMe SSD (default RAID 10)
Heat Dissipation Peak: 2,679BTU/hr	Mounting System: 4U 19" rack mount	

System connectivity I/O

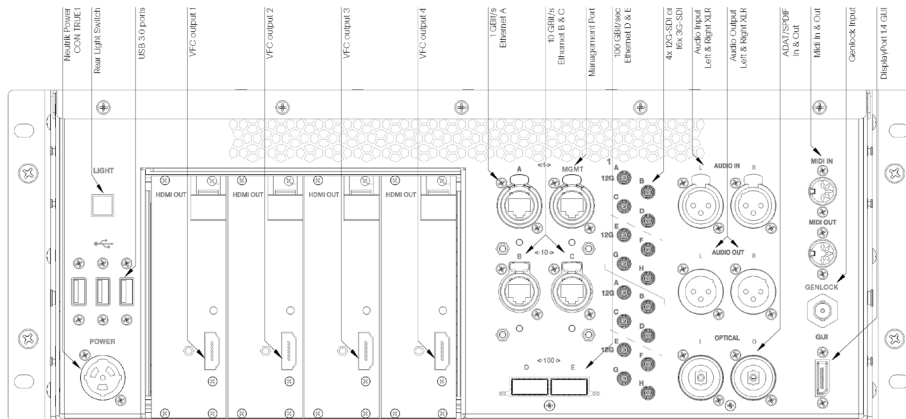

Video Output: 1x Displayport 1.4 (GUI) 4x VFC Output Slots Ships standard with HDMI 2.0 VFC cards	Audio: 2x Balanced XLR input (circular 3-pin connector) 2x Balanced XLR output (circular 3-pin connector) 1x 1/4" Headphone Jack Optical Audio ADAT/SPDIF (Toslink connector) - 1x in, 1x out MIDI: MIDI (circular 5-pin DIN connector)- 1x in, 1x out	General Network: 1x 1Gb/sec Ethernet 2x 10Gb/sec Ethernet High Speed Network: 2x 100Gb/sec Ethernet System Management Controller: 1x Management Port (Ethernet)
Different Video Format Conversion Cards also available, refer to VFC specifications		Data/Peripherals: 5x USB 3.0 (2 front, 3 rear) Video Sync: 1x BNC Genlock
Video Input: 4x 12G-SDI or 16x 3G-SDI (HD-BNC connectors)		